

5. SUCTION VALVE ASSEMBLY - LP - HP

(HX2T 75-100NP)

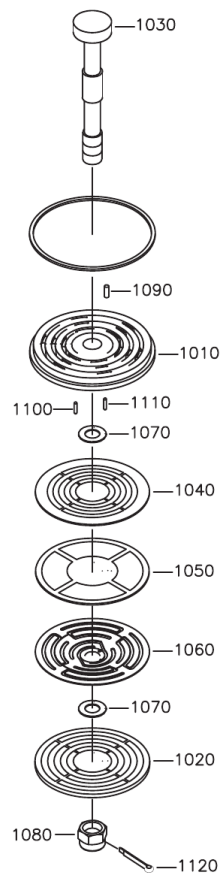

5. SUCTION VALVE ASSEMBLY - LP - HP

(HX2T 75-100NP)

Ref	Part Number	Qty	Description	Remark	Ref	Part Number	Qty	Description	Remark
1010	1903 6175 03	1	Valve seat						
1020	1903 6177 03	1	Valve keeper						
1030	1903 3303 04	1	Centre stud						
1040	1903 2225 05	1	Valve plate						
1050	1903 2226 05	1	Damper plate						
1060			Spring plate						
-	1903 2249 05	2	LP-cylinder						
-	1903 2249 05	3	HP-cylinder						
1070	1903 1004 08	2	Lift washer						
1080	1903 2222 13	1	Castle nut						
1090	1903 4843 13	1	Dowel pin						
1100	1903 5038 13	1	Roll pin						
1110	1903 5039 13	1	Roll pin						
1120	1903 5108 13	1	Split pin						
	1903 0051 95		Valve service kit (LP-cylinder)						
-	1903 2225 05	1	Valve plate						
-	1903 2227 05	2	Spring plate						
-	1903 0210 08	1	O-ring						
-	1903 0212 08	1	O-ring						
-	1903 1004 08	2	Lift washer for valve assly.						
-	1903 3624 13	1	Copper gasket						
-	1903 5108 13	1	Split pin						
	1903 0053 95		Valve service kit (HP-cylinder)						
-	1903 2225 05	1	Valve plate						
-	1903 2227 05	3	Spring plate						
-	1903 0210 08	1	O-ring						
-	1903 0212 08	1	O-ring						
-	1903 1004 08	2	Lift washer for valve assly.						
-	1903 3624 13	1	Copper gasket						
-	1903 5108 13	1	Split pin						